

2/7/2005

Mr. Ahmer Nizam, Rail Engineer  
 Washington Utilities & Transportation Commission  
 Rail Safety Inspection Program  
 1300 S. Evergreen Park Drive SW  
 Olympia, WA 98504-07250

**RECEIVED**

FEB 08 2005

**WASH. UT. & TP. COMM**

RE: Request for Rail Clearance Waiver

Dear Mr. Nizam:

Please find enclosed scope documents regarding a rail clearance situation that I believe to require a waiver.

Scope

The Port of Tacoma maintains rail tracks that cross 11<sup>th</sup> street on the North side [See Illustration 1/12; 2/12, attached]. Due to recent emphasis on security concerns, the Port of Tacoma has been hardening its secure perimeter. Running parallel to 11<sup>th</sup> street and crossing rail tracks, this perimeter will take the form of hydraulically operated gates at the rail crossings installed in an existing 8' steel fence..

There are four gates in question [See Illustration 2/12], three of which I do not believe to represent any clearance problems [R1, R2 and R3].

However, the gate identified as R4 crossing a rail spur and utilized infrequently [twice a week or so], appears to represent a clearance problem. This rail spur historically appears to represent a clearance problem as old signage identifies a power pole as being a hazard [See Illustration 10/12; 12/12].

Request for Waiver

This letter is to request a waiver for the installation of Gate R4. The logic we are offering is that while this gate falls within 8'-6" established from center of rail to obstruction, this gate does not exceed those clearances established with the existing power pole that has existed in this location for decades. [See Illustration 6/12; Photographs 10/12 and 12/12.]

Additionally, while we seek clearance for this specific gate, we have provided information regarding gates R1, R2 and R3 to confirm that these gates maintain 8'-6" clearance to the centerline of existing rail installations.

We understand from our conversation that you desire documentation for these installations, and that you will desire to visit the Port of Tacoma to confirm these conditions. You are of course welcome here any time.

We hope this is satisfactory and look forward to your trip.

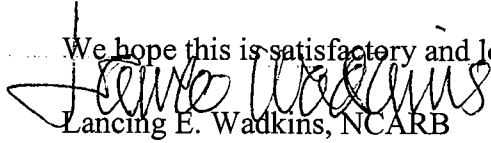
A handwritten signature in black ink, appearing to read "Lancing E. Watkins". The signature is written in a cursive style with a large initial "L".

Lancing E. Watkins, NCARB

Project Manager



**PORT OF  
TACOMA  
U.S.A.**

**PORT OF TACOMA  
PLANNED RAIL  
TACOMA RAIL  
BNSF  
BNSF TRACK WITH UPRR TRACKAGE RIGHTS  
UPRR  
PRIVATE  
CITY OF TACOMA**

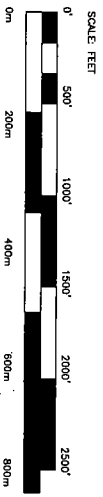

SCALE: FEET  
0' 500' 1000' 1500' 2000' 2500'  
SCALE: METERS  
0m 200m 400m 600m 800m  
REVISED DATE: 08 JULY 2004  
L:\A\BNSFMAP\VALBASE\TERMINALS.DWG

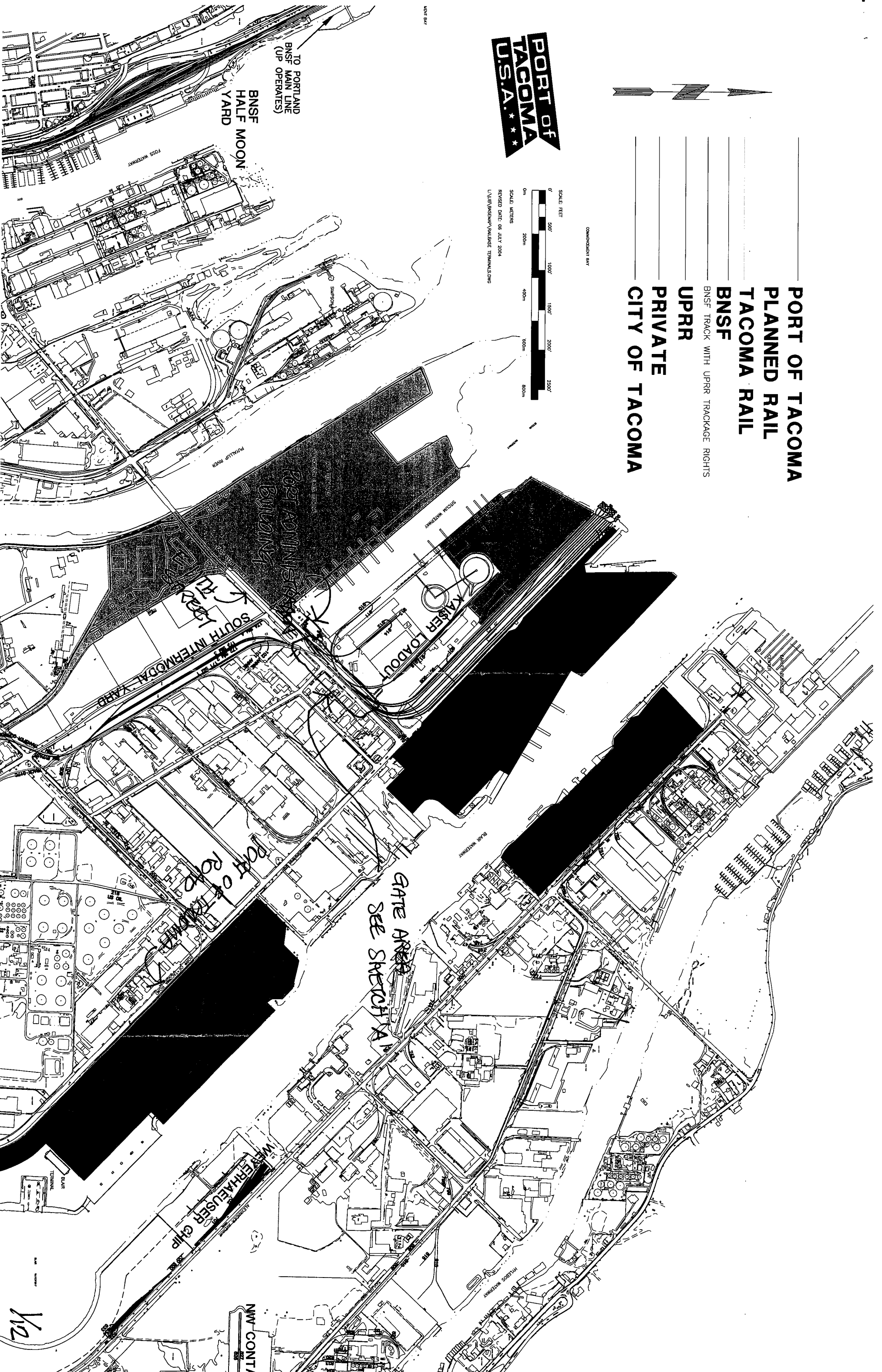

1/2

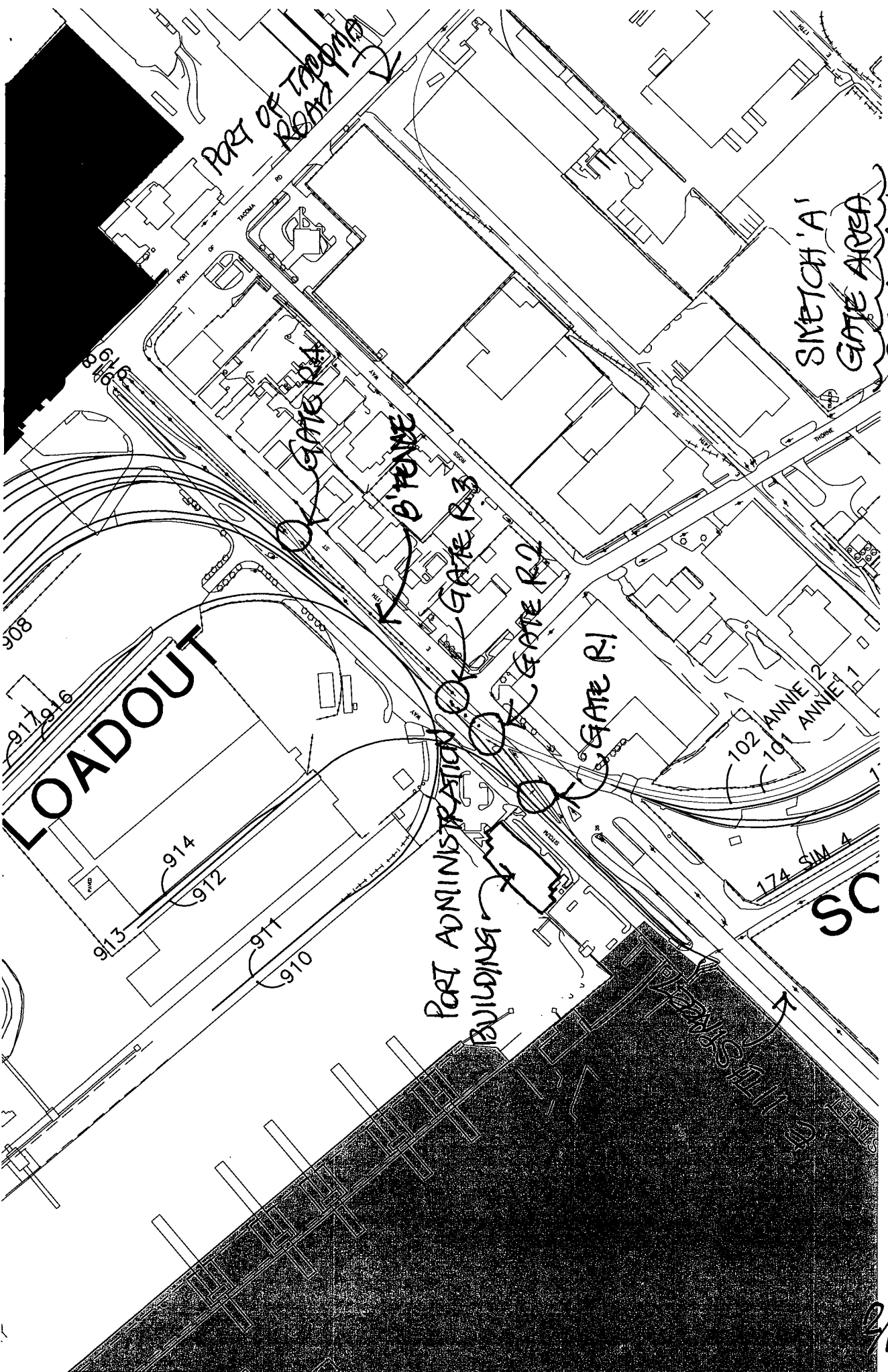

SKETCH 'A'  
GATE AREA  
SEE ATTACHED  
PHOTOS.

2/12

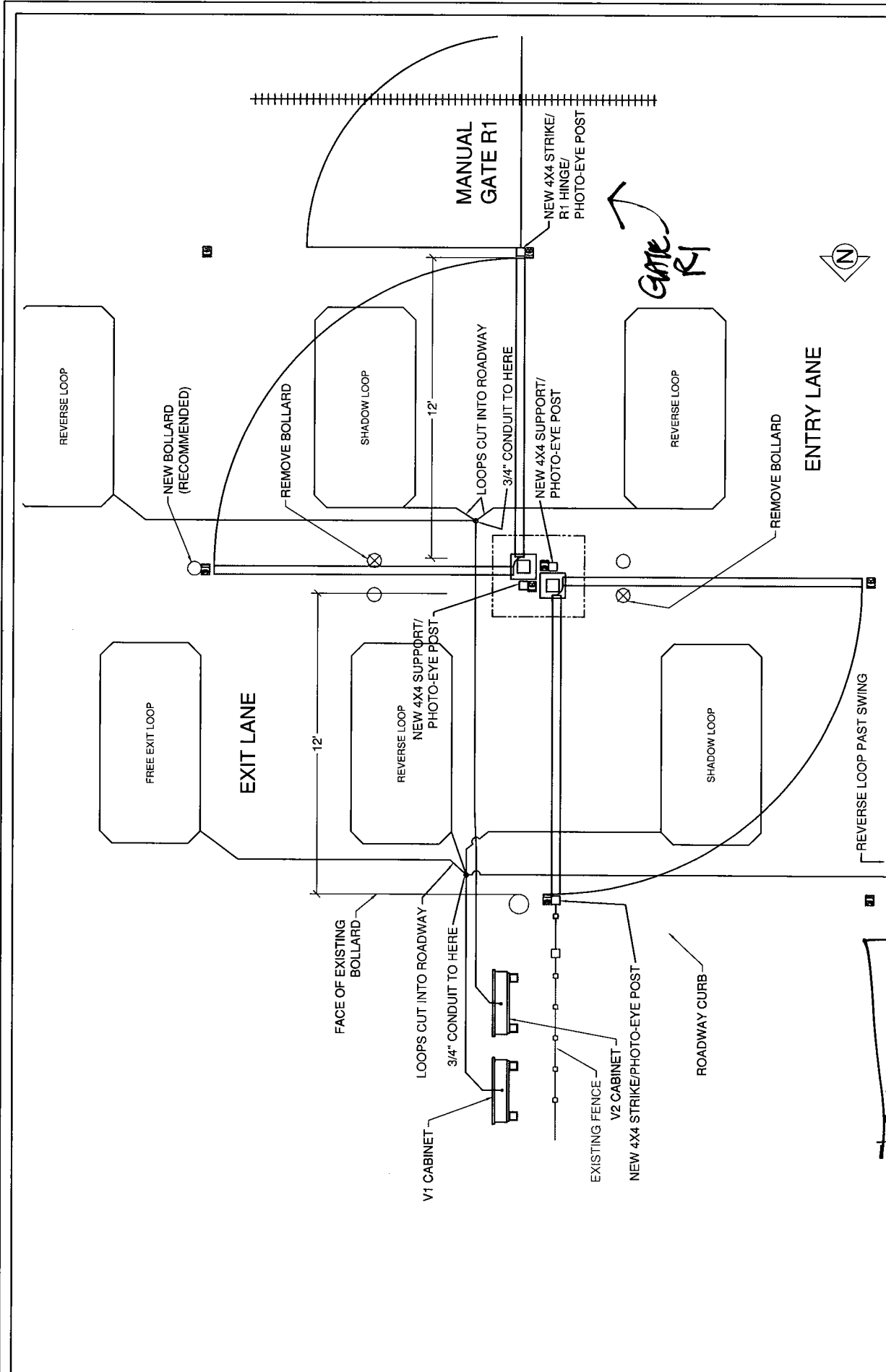

VEHICLE GATES V1 & V2  
PLAN VIEW

3/12

JOB NAME: Port of Tacoma/REP Electric  
 DATE: 12-17-04 REVISED: #  
 DRAWN BY: JH PAGE: OF:

**Automated**  
**Gate**

Automated Gates & Equipment Co. 10847 E. Marginal Way So., Seattle, WA. 98168 206-767-9080

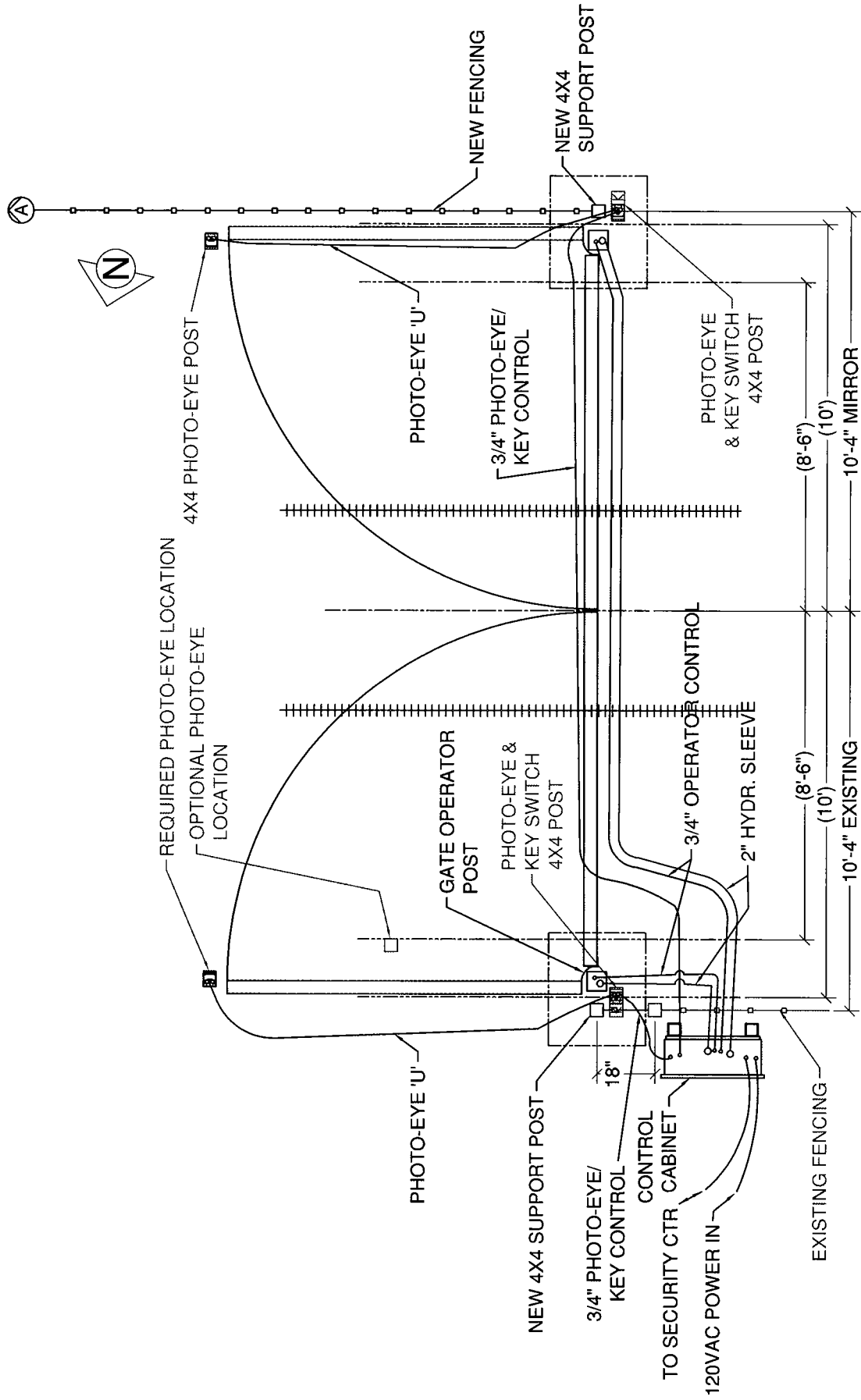

JOB NAME: Port of Tacoma/REP Electric  
 DATE: 12-17-04 REVISED: #  
 DRAWN BY: JH PAGE: OF:

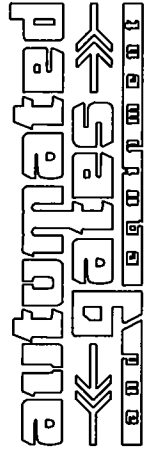

Automated Gates & Equipment Co. | 10847 E. Marginal Way So., Seattle, WA, 98168 206-767-9080

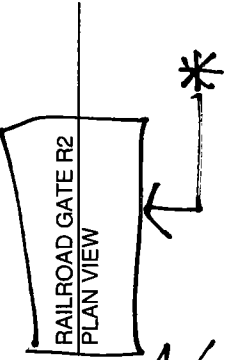

4/12

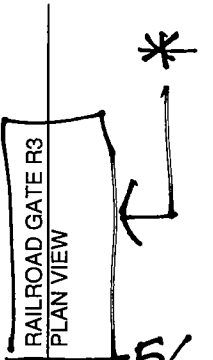
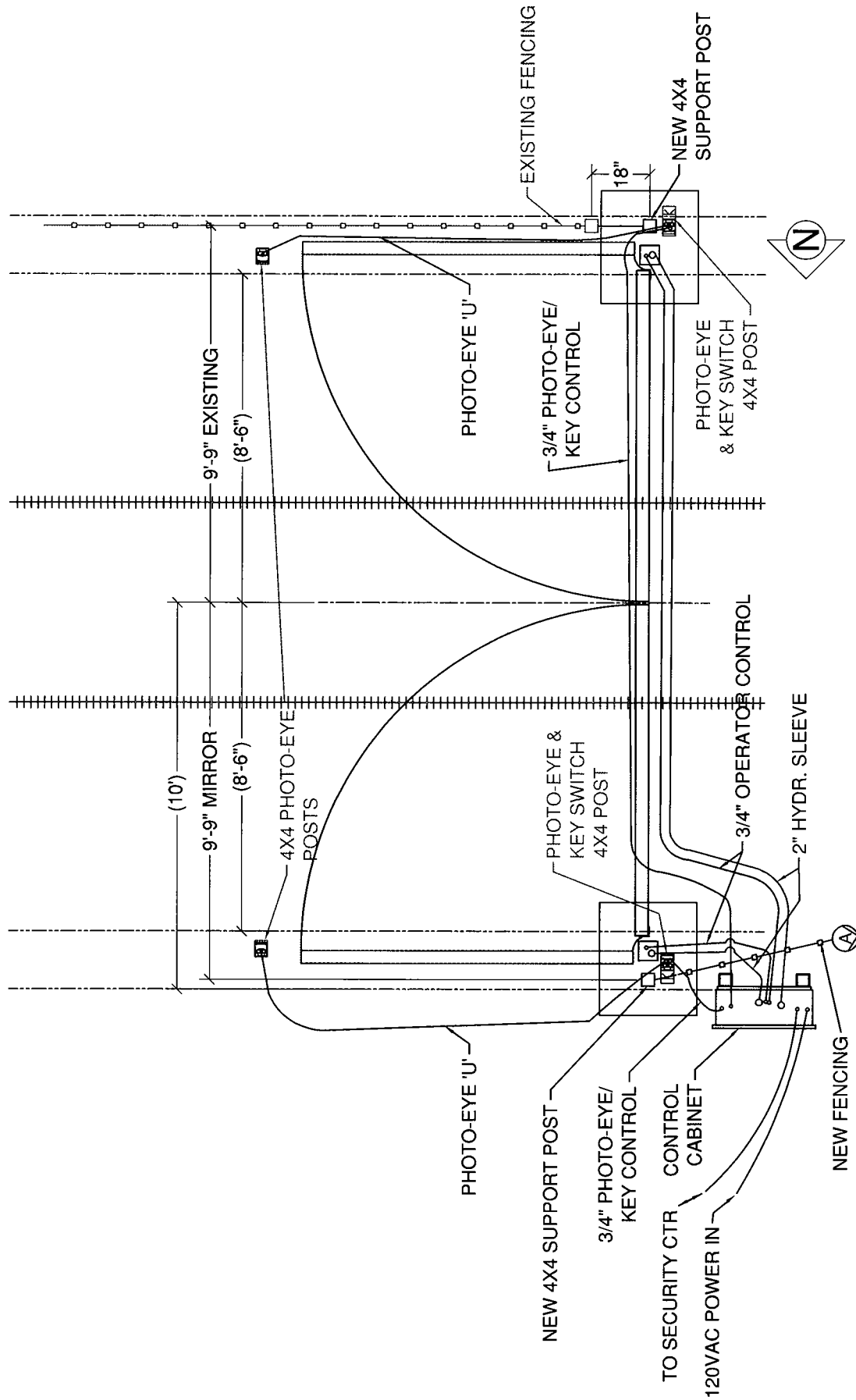

5/12

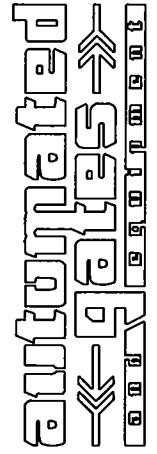

JOB NAME: Port of Tacoma/REP Electric

DATE: 12-17-04 REVISED: #

DRAWN BY: JH PAGE: OF:

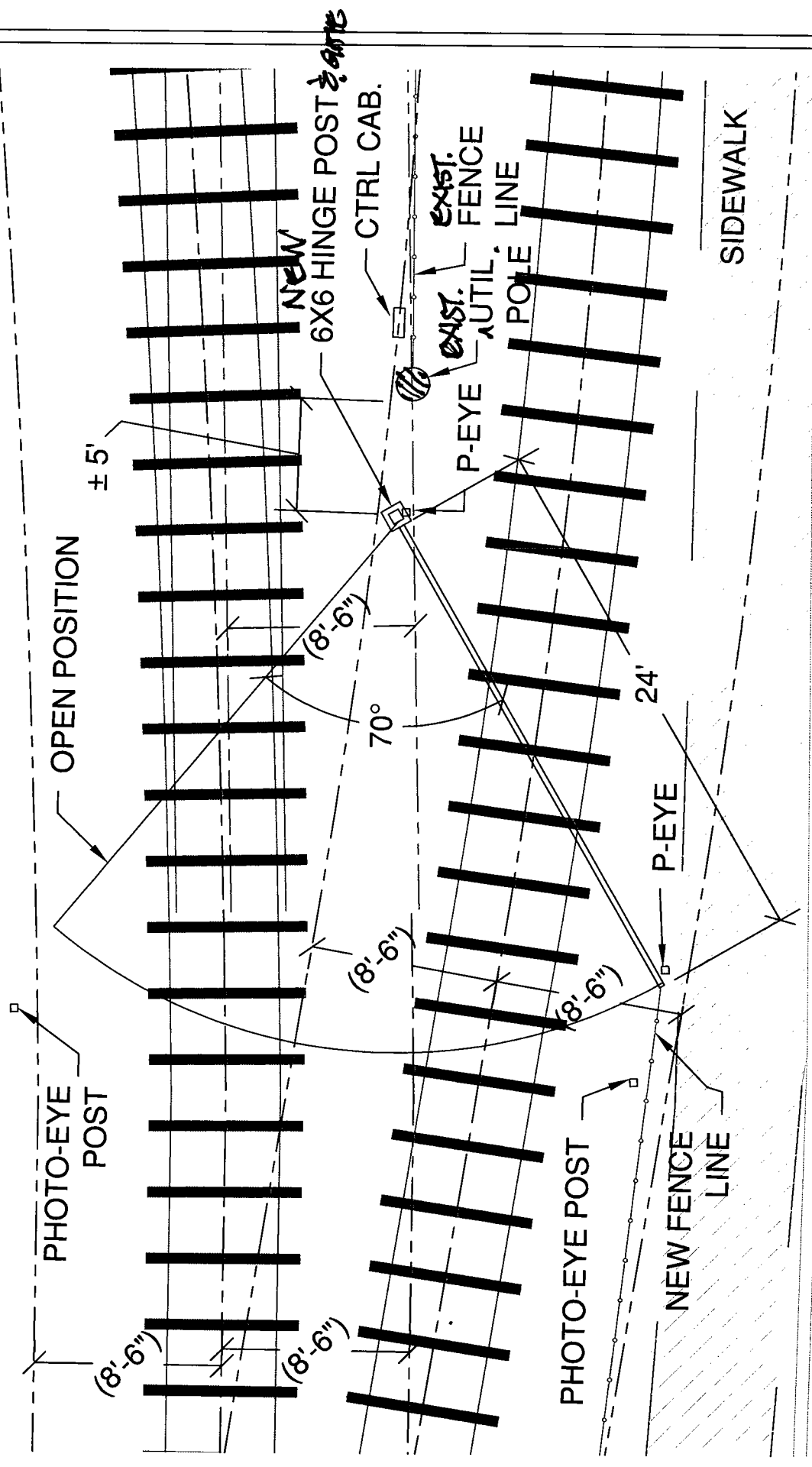

11th STREET

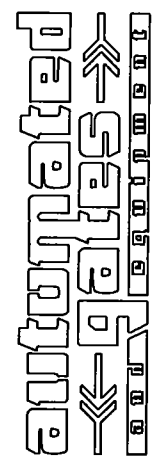

R4 SINGLE SWING GATE PROPOSAL  
 BY AN 900 OPERATOR

JOB NAME: PORT OF TACOMA  
 DATE: 1-18-05  
 DRAWN BY: JH  
 REVISED:  
 PAGE: 1 OF: 1

Automated Gates & Equipment Co. 10647 E. Marginal Way So., Seattle, WA. 98168 206-767-9080

6/12



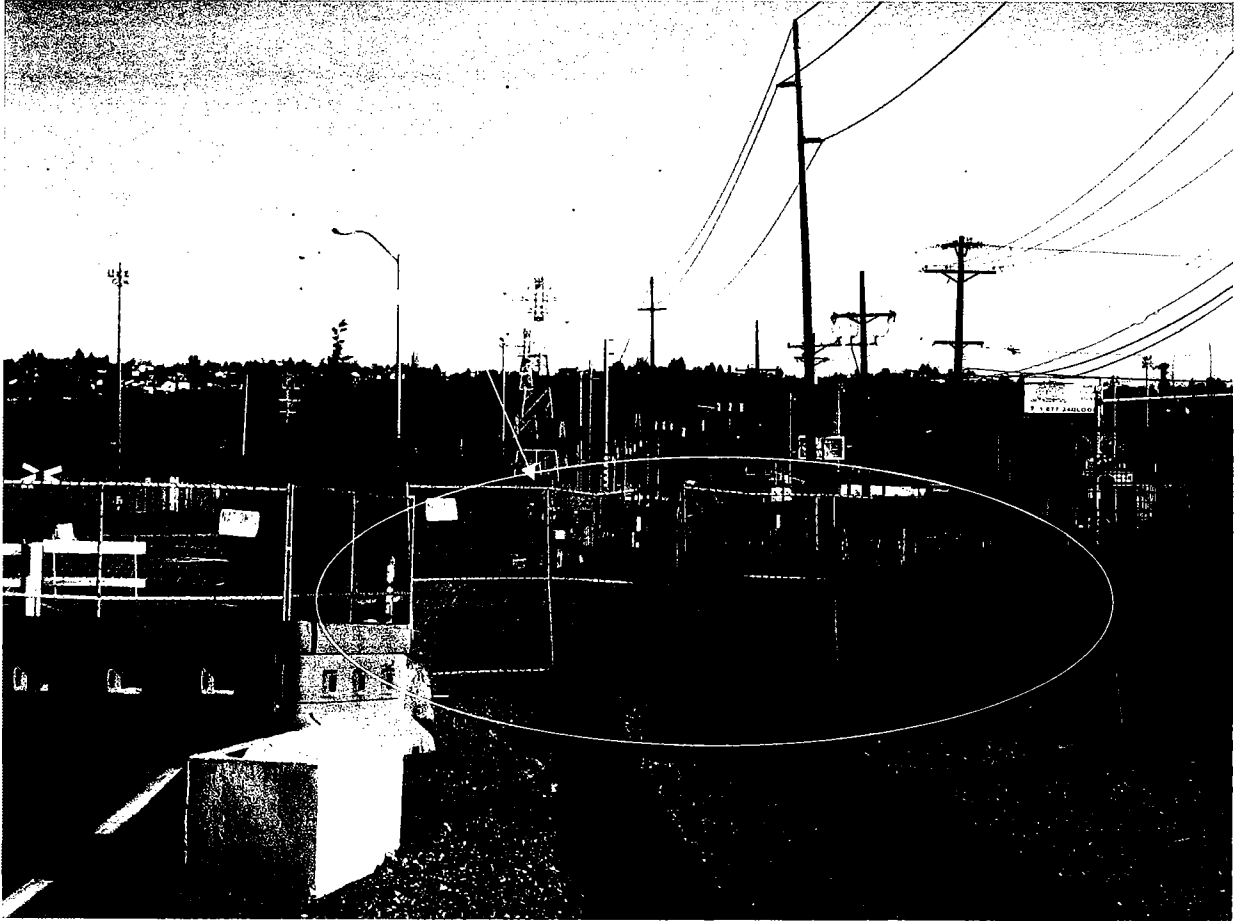

Gate R1 – Looking East

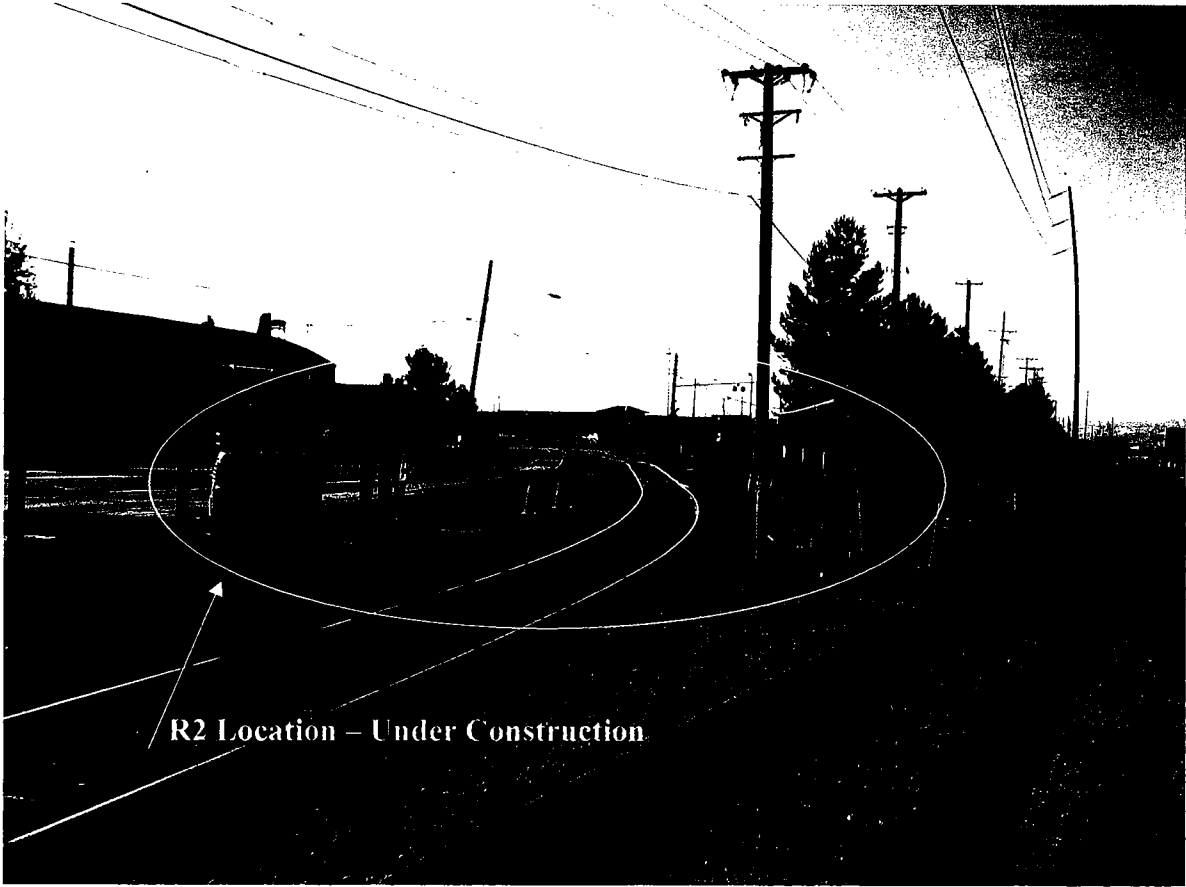

R2 Location - Under Construction

Gate R2 - looking South West

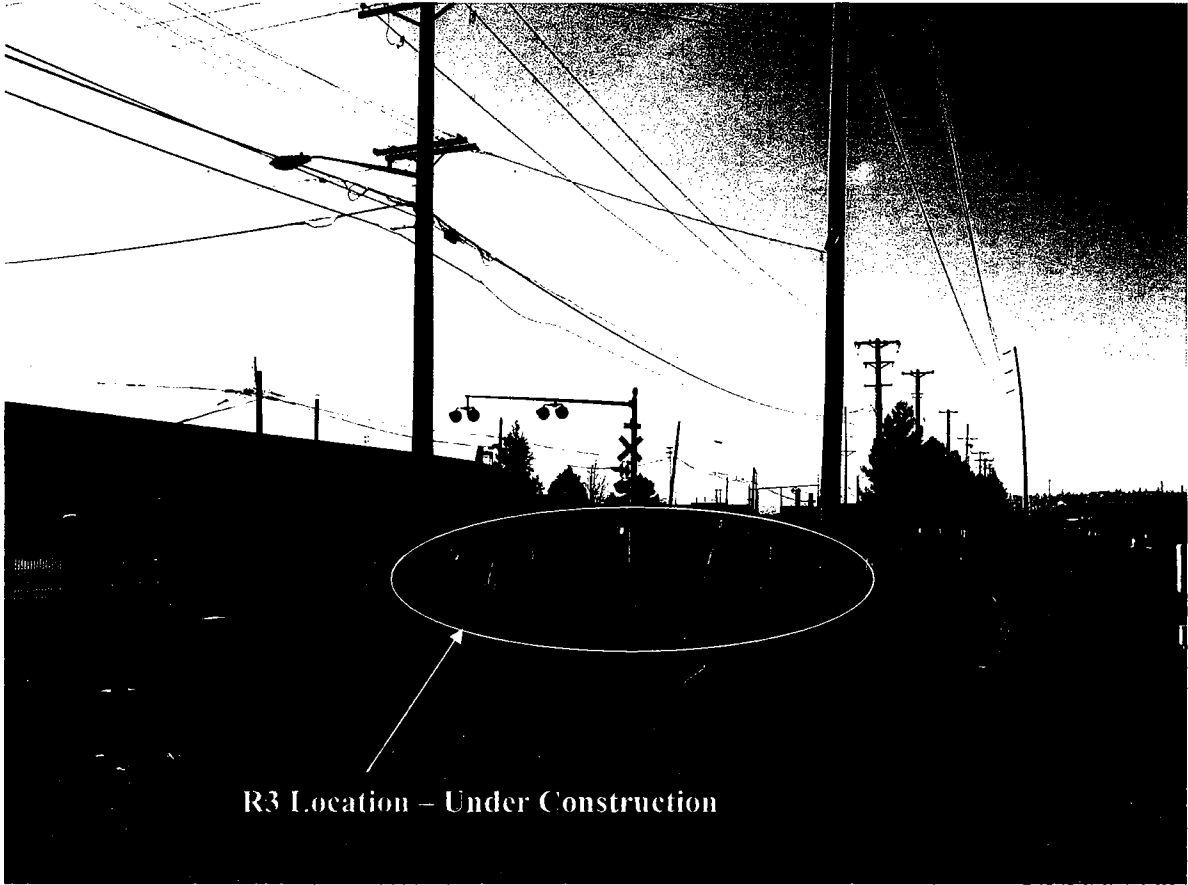

R3 Location - Under Construction

Gate R3 - Looking South West

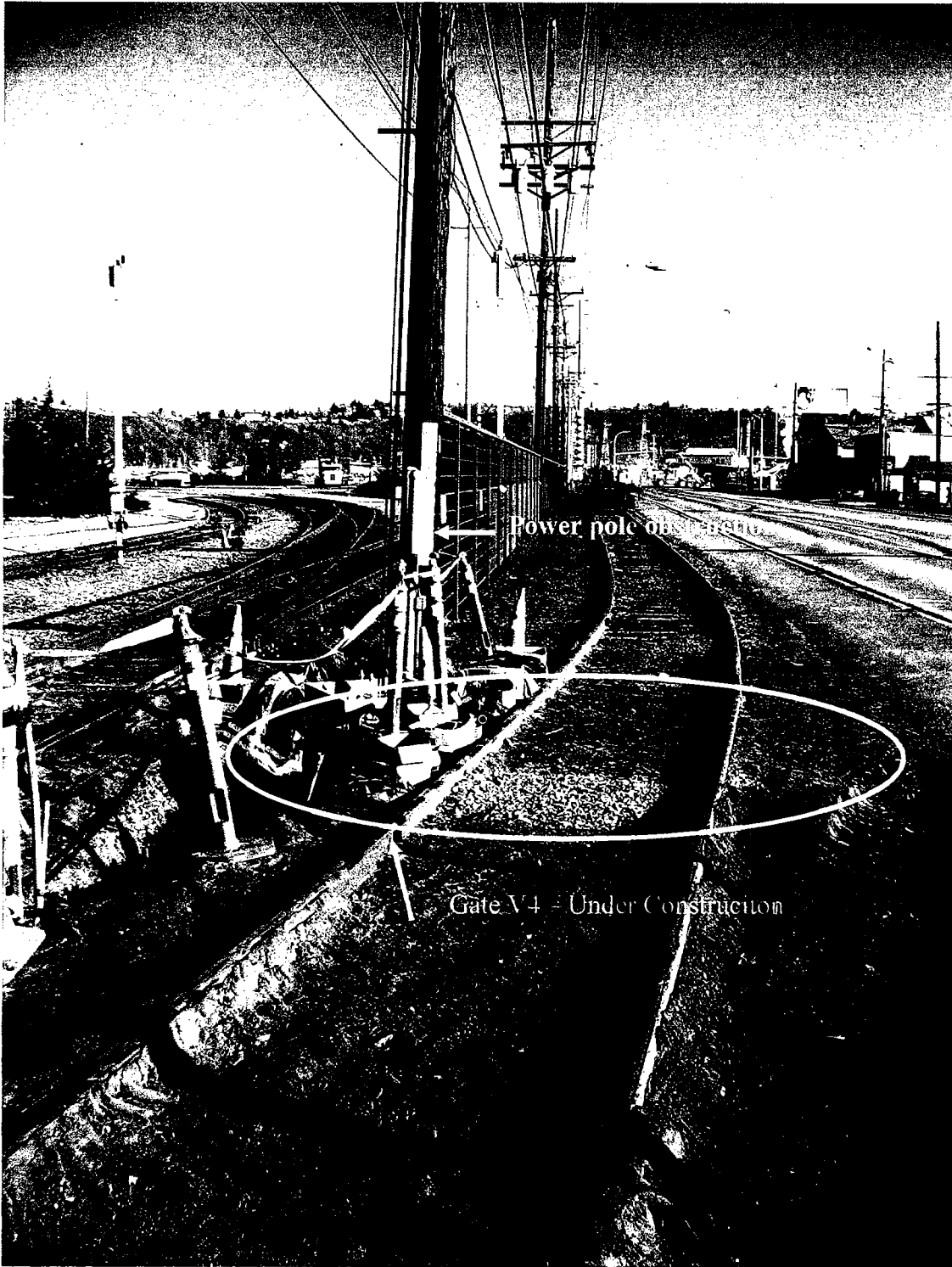

Gate R-4 Looking North East  
Showing track geometry and power pole clearance

10/12

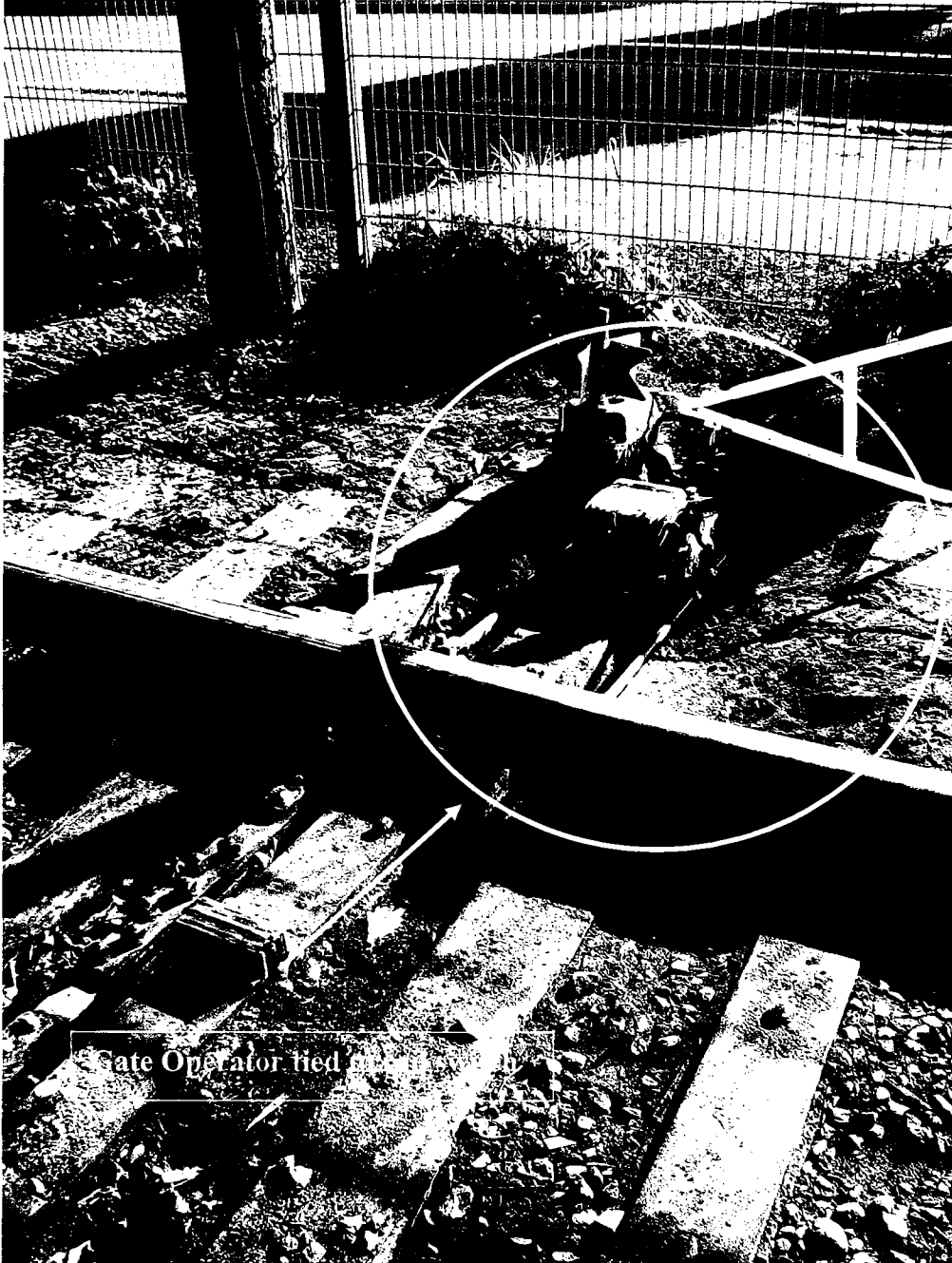

Gate R4 – Switch/Gate Operator

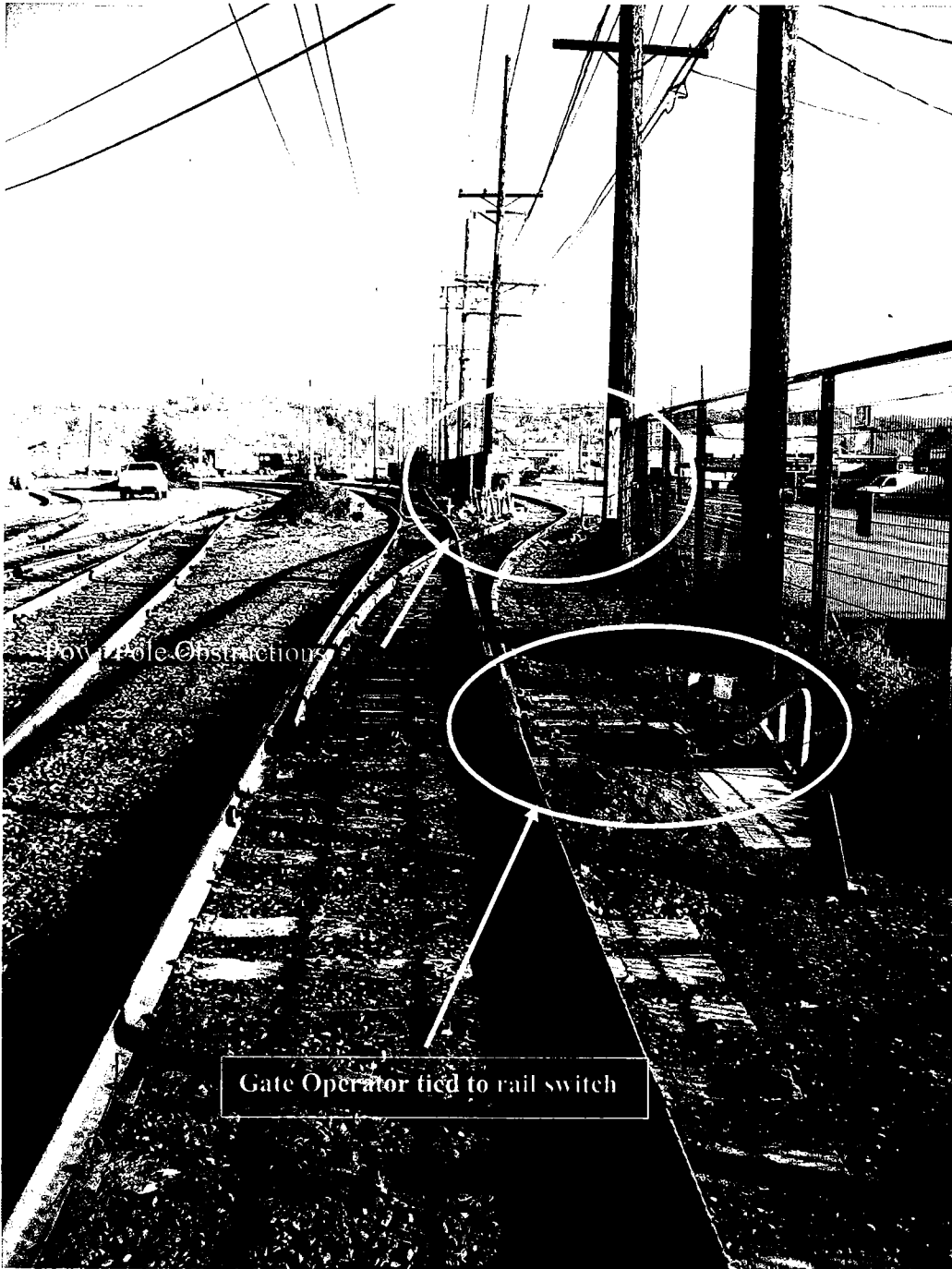

Gate R-4 Looking North East showing telephone clearance warning signs on two poles.

12/12